



## PROJECT DELIVERABLES

### CLIENT

The Australian National University

### ARCHITECT/REFEREE

MDa

### PROJECT VALUE

\$5M

### DELIVERY MODEL

Managing Contractor

### PROJECT SECTOR

Education

### DURATION

N/A

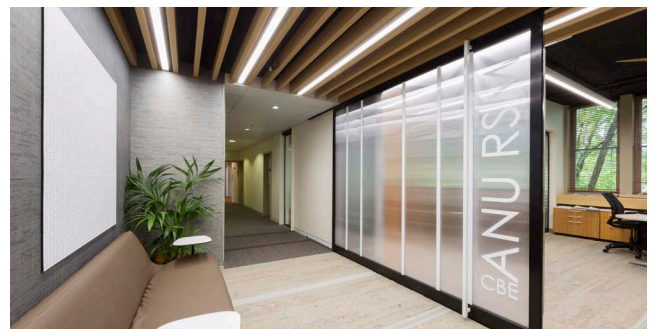
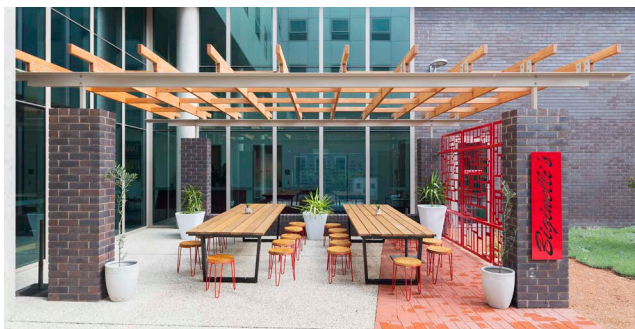

# ANU College of Business and Economics Building Upgrades

## OVERVIEW

PROJEX Building Group have undertaken various refurbishments and building upgrade works within the College of Business and Economics (CBE) buildings at the Australian National University (ANU) to a combined value of approximately \$5m.

The works have included a new cafe, courtyard and landscape upgrades, new student hub and glazed airlock, refresh of corridors and common areas, refurbishments to the various school's teaching spaces, administrative offices and amenities.

Some of the more notable projects include:

- CBE Connect Student Hub and Airlock (\$2.1M)
- CBE Cafe and Foyer Upgrade (\$300k)
- CBE Courtyard Upgrade (\$300k)
- Research School of Management Fit-Out (\$520k)
- CBE Demonstration Space (\$415k)
- Research School of Finance, Actuarial Studies & Statistics Refurbishment (\$350k).

## KEY CHALLENGES

A key challenge which was consistent in the delivery of all projects within the College was the completion of extensive refurbishment works whilst minimising disruption to the Universities operations.

With the CBE being one of the largest and busiest College's at the ANU, thorough and regular communication was required with the project control group to understand the University teaching timetable, exam timing and various building functions and events which were held quite regularly. PROJEX had to be flexible in the sequencing and programming of construction works and adapt to the ANU's requirements.

Staging of construction work and strict site establishment measures allowed PROJEX to deliver the works in a safe and undistruptive manner whilst in line with the Universities delivery program.